



Blow-off zone

Function and purpose

In general, the blow-off zone is placed at the exit of the pretreatment tunnel. It can, however, be an integrated part of the tunnel as well.

The purpose is to remove surface water as well as pits of water captured due to hanging/geometry of the parts.

Accurate and energy saving

The special blow-off nozzles can be pointed in different directions and is designed to achieve high impact also at a distance.

This combination makes the zone very efficient with a low energy consumption.



The adjustable nozzle can be directed manually to perform optimally with a low energy consumption.

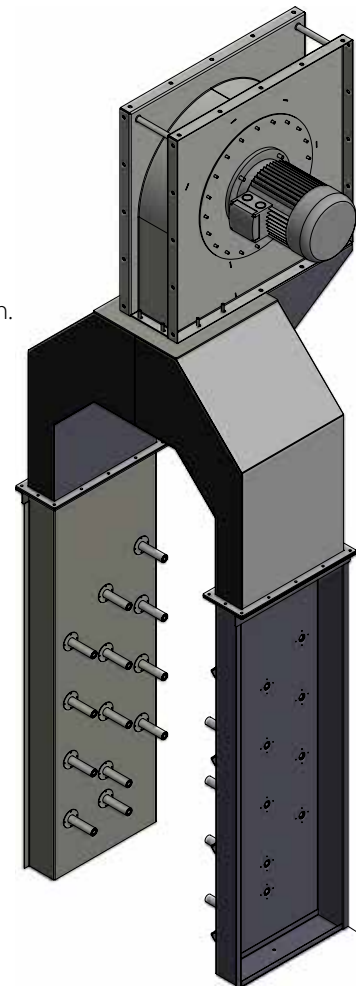
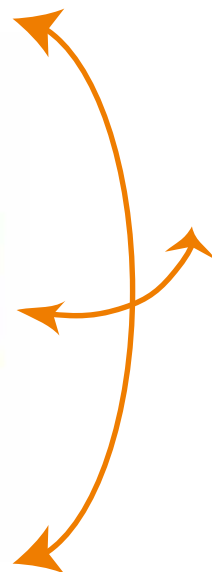

Energy saving

A blow-off zone reduces the water needed to be evaporated in the dryer, and will therefore save energy for the drying oven.

Efficiency

The AABO-IDEAL blow-off zone has a frequency controlled motor. This allows the control to adjust the power according to the part/item.

This again prevents smaller items from being blown off the jigs, and allows maximum impact on larger items with the same unit.

Materials

Where water contact is present, the blow-off zones are constructed in stainless steel.

All other components are constructed in powder coated steel.

Integrated or stand alone

The blow-off zone can be installed integrated in the tunnel or as a stand-alone unit after the exit.

The blow-off zone can be installed on existing lines.

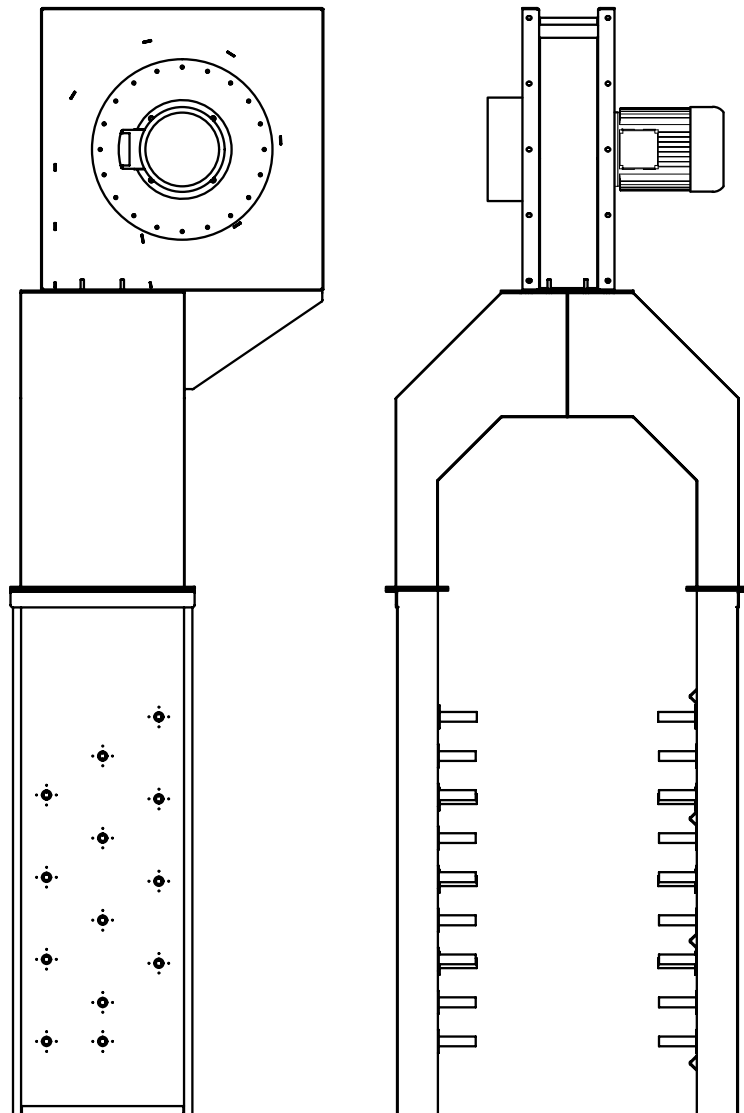

HIGHLIGHTS

- Speeds up water drip off and evaporation
- Highly adjustable nozzles
- Operates with efficiency and accuracy
- Saves energy for the next process

